

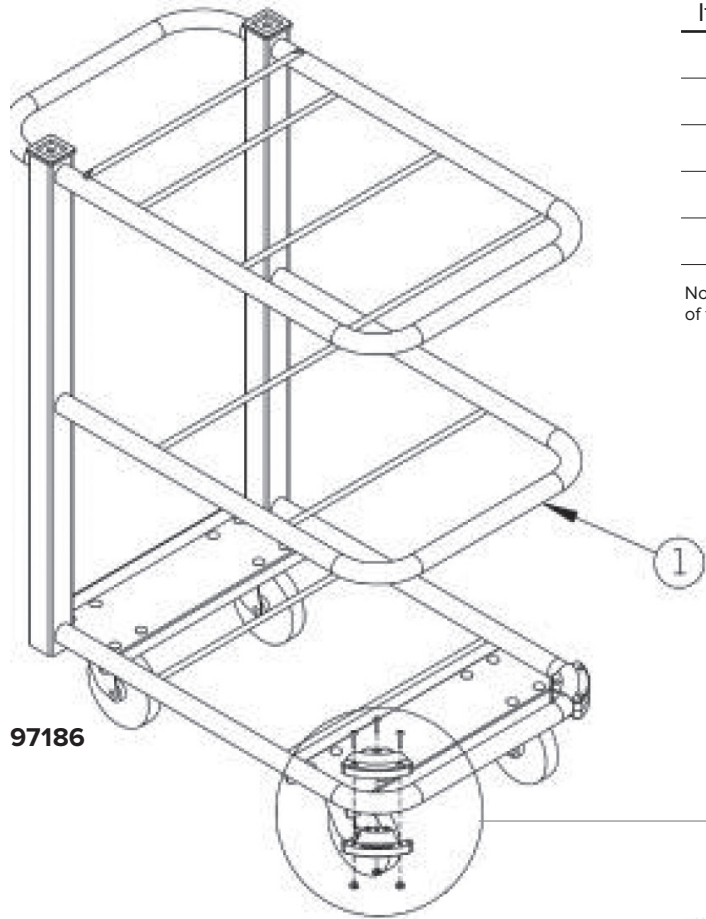

Bumper Assembly Instructions for Cantilever Carts

(Item 97186 and 60047)



97186

Item No.	Qty	Description
1	1	Body Assembly
2	2	Bumper – Top
3	2	Bumper – Bottom
4	6	#8-32 UNC Hex Nut
5	6	#8-32 x 3/4" Long Screw

Note: The bottom bumper has hex openings the same shape of the hex nuts.

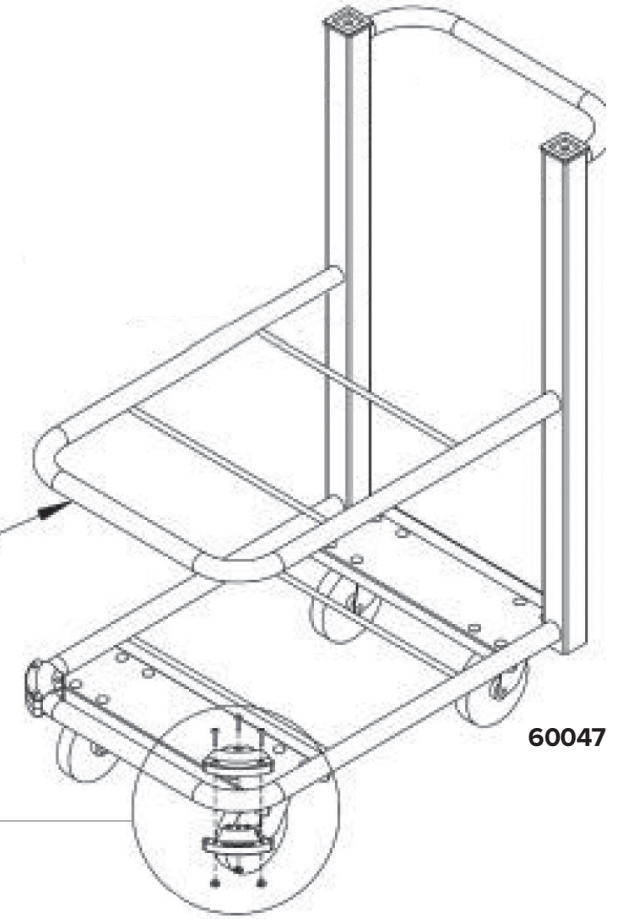
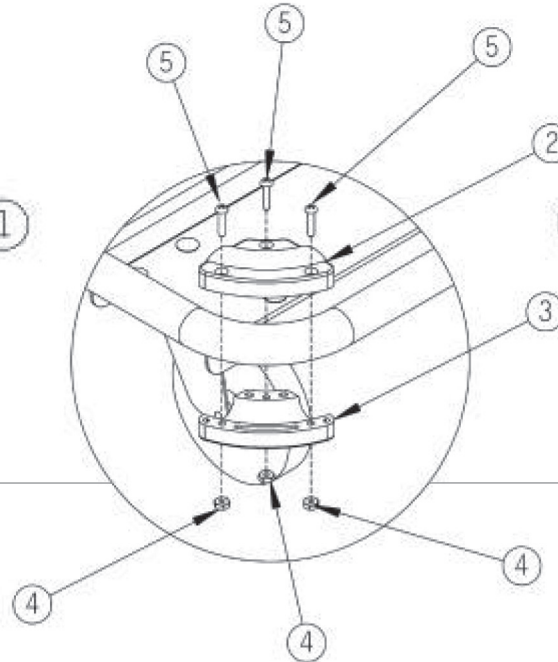

60047

www.vollrath.com

The Vollrath Company, L.L.C.
1236 North 18th Street
Sheboygan, WI 53081-3201 U.S.A.
Main Tel: 800.624.2051 or 920.457.4851
Main Fax: 800.752.5620 or 920.459.6573
Customer Service: 800.628.0830
Canada Customer Service: 800.695.8560

Technical Services
techservicereps@vollrathco.com
Induction Products: 800.825.6036
Countertop Warming Products: 800.354.1970
Toasters: 1.800.309.2250
All Other Products: 800.628.0832